



# Your partners in Decontamination



---

# Partnered with W&H

To offer you the best service possible with the highest quality of equipment Wright Cottrell now works in partnership with W&H to become the exclusive national distributor of W&H sterilising products in the UK.



02\_ PLANNING AND LAYOUT

03\_ BRONZE PACKAGE

04\_ SILVER PACKAGE

06\_ GOLD PACKAGE

08\_ WARRANTY & VALIDATION

BC\_ W&H WEB SUPPORT  
FINANCIAL PLANS

# Working with you from start to finish

Wright Cottrell will work in partnership with you from the first initial meeting, fulfilling all your requirements to create an HTM 01-05 compliant decontamination room. With our excellent customer service and knowledge we will advise you on future proofing and offer a follow-up beyond installation, to service and validation, for the life, of your LDU, giving you complete peace of mind. To make the process easy and uncomplicated, we have created 3 unique packages, bronze, silver and gold, that allow you flexibility, regardless of size and budget.

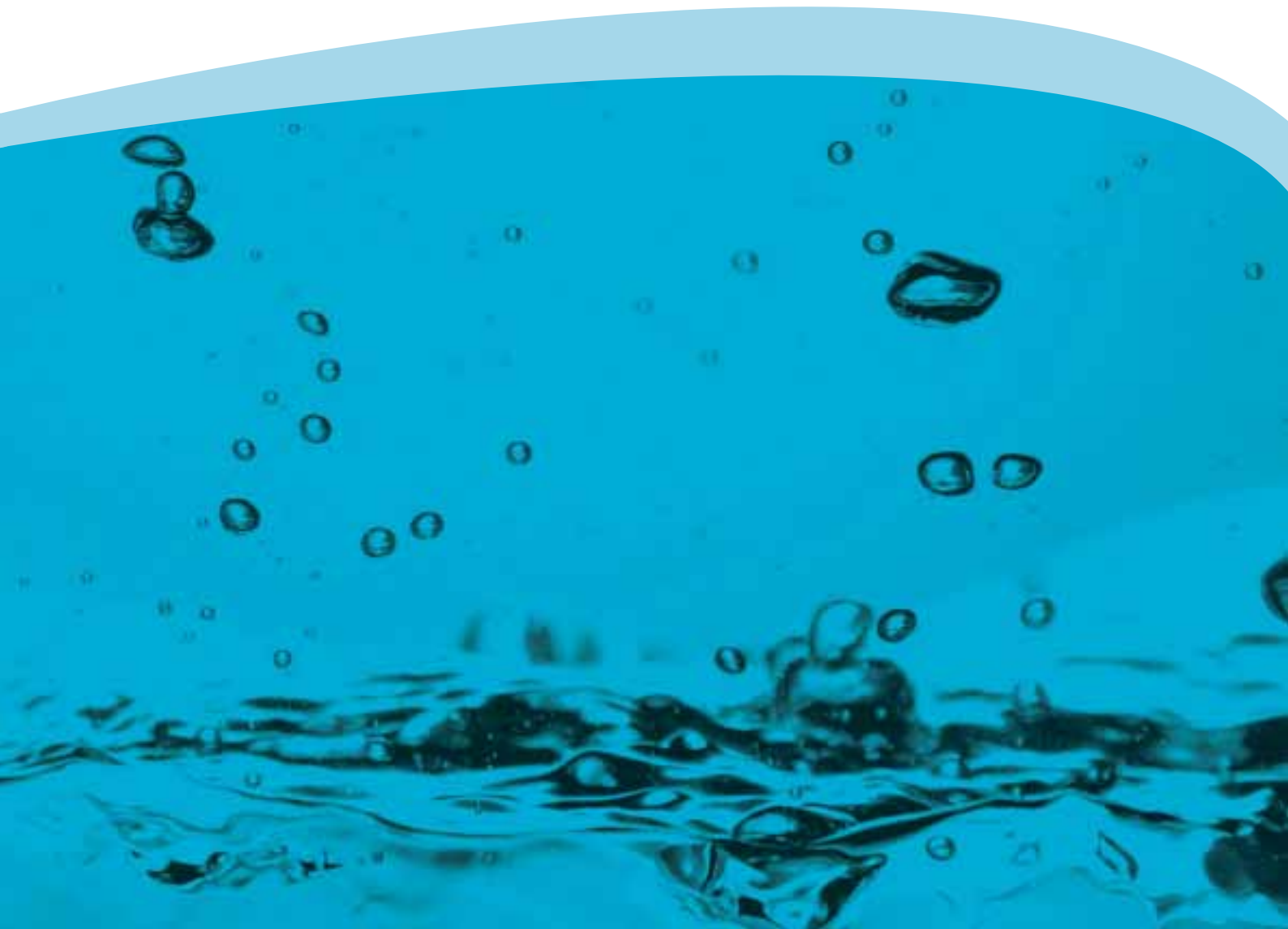

# Good planning, layout and installation

Each Package consists of:

- **Basic layout**
  - up to 6m worktop
  - 2 sinks
  - 1 bin
  - 2 storage cabinets
- **Various optional add-ons**

HTM 01-05 compliance begins with good planning and it needs to be right 1st time, saving you valuable time and money. From the beginning Wright Cottrell will work with you to create and plan the perfect sterilisation room for your dental practice. All planning will work within our unique bronze, silver and gold package, offering advice to ensure you are fully compliant now and have flexibility, for the future.

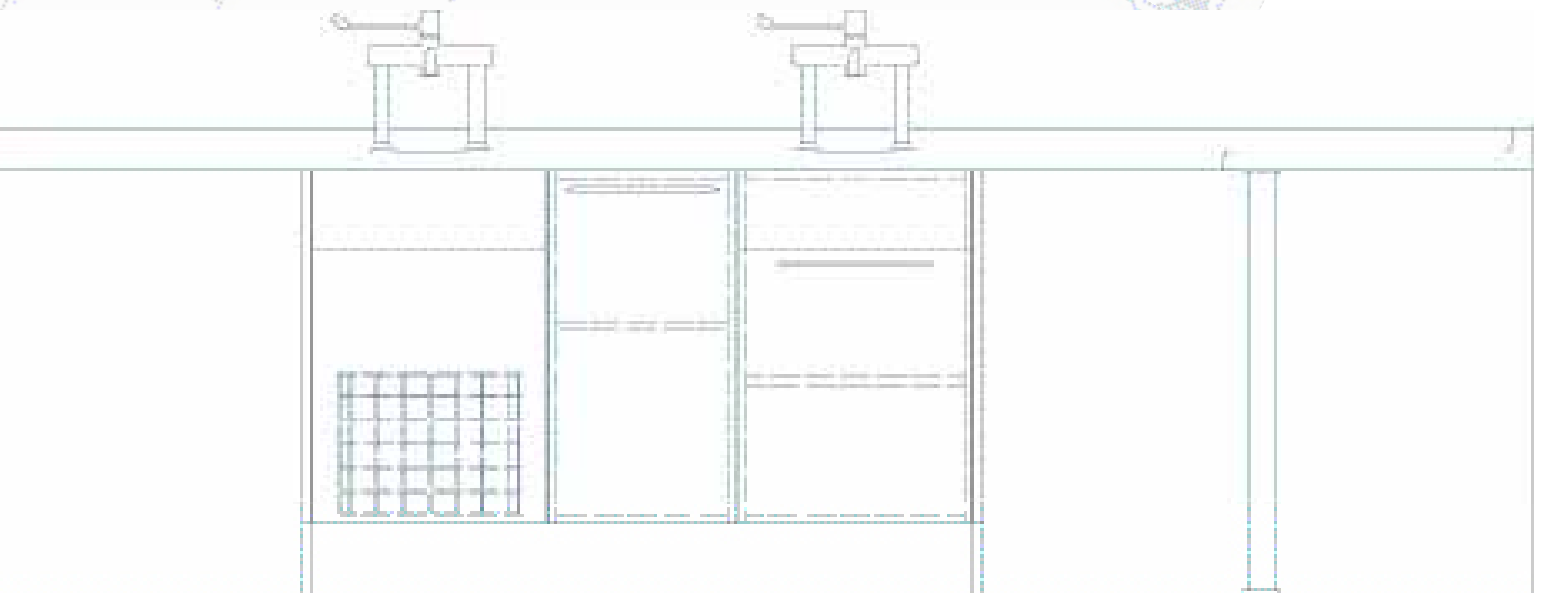

# Bronze Package

The bronze package offers you a cost-effective solution for all your decontamination requirements, working within our basic layout, we will supply you with a laminate worktop and melamine faced cabinetry, underbench disinfector and non vacuum steriliser. As with all our packages we can include additional options to make sure the package is tailored to you.

Package contains

- MS Non Vacuum 22 Litre Autoclave
- Data Logger or Printer
- ThermoKlenz Underbench Washer Disinfector
- KlenzSecure Data Logger
- Dentalstyle Cabinetry

THERMOKLENZ UNDERBENCH WASHER DISINFECTOR



Features:

- Fully compliant to EN15883 and HTM2030
- Compact exterior with spacious interior
- Full load cycle wash, in <60 minutes
- Choose between three cycle types
- Self-dosing detergent dispenser gives consistent results whilst being economical
- Unique air gap to comply with BSEN 1717:2001
- Data logger or printer for data capture
- Reverse Osmosis (RO) water connection for future proofing

MS NON VACUUM 22LITRE AUTOCLAVE



Features:

- Fully compliant to EN15883 and HTM2030
- More benefits for less cost
- A low maximum power consumption of 1.75kWh
- Large 22 litre capacity chamber
- Extended service intervals
- Standard 134 N-cycle
- HTM 01-05 compatible
- Cycle Date Recording
- LED Screen
- Servicing Installation & Testing
- 2 Year or 2000 cycle manufacturer's warranty

Additional options:

- Double base
- Corner base
- Base, 1 door,
- Base, twin tray storage
- Open base with slide.
- Washer disinfector housing
- Base, 4 Drawer unit
- Wall, single unit, tray storage
- Wall, double unit

# Silver Package

## Package contains

- Lina Vacuum 17Litre Autoclave
- Data Logger or Printer
- ThermoKlenz Underbench Washer Disinfector
- KlenzSecure Data Logger
- W&H Assistina
- Fluid Pack
- 2 Clip Trays
- Dentalstyle Cabinetry

## Additional options:

- Double base
- Corner base
- Base, 1 door,
- Base, twin tray storage
- Open base with slide.  
Washer disinfector housing
- Base, 4 Drawer unit
- Wall, single unit, tray storage
- Wall, double unit

The silver package offers you an excellent solution for all your decontamination requirements, working within our basic layout, we will supply you with a senza solid surface worktop and laminate faced cabinetry, underbench disinfector, vacuum steriliser, traceability and instrument maintenance equipment. As with all our packages we can include additional options to make sure the package is tailored to you.

LINA VACUUM  
17LITRE AUTOCLAVE



Features:

- Fully compliant to EN15883 and HTM2030
- Adaptable to your practice requirements
- Hospital grade type-B cycles
- Short ECO-B cycle for small loads
- Designed certified and validated with the most stringent directives and standards
- Ease of use, big capacity and saves room

THERMOKLENZ UNDERBENCH  
WASHER DISINFECTOR



Features:

- Fully compliant to EN15883 and HTM2030
- Compact exterior with spacious interior
- Full load cycle wash, in <60 minutes
- Choose between three cycle types
- Self-dosing detergent dispenser gives consistent results whilst being economical
- Unique air gap to comply with BSEN 1717:2001
- Data logger or printer for data capture
- Reverse Osmosis (RO) water connection for future proofing

W&H ASSISTINA



Features:

- Care and maintain instruments
- Lifespan of instruments are increased significantly
- Reduced service costs
- Very economical
- Simple, convenient and safe
- Only 35 seconds cycle

EXAMPLE OF DENTALSTYLE CABINETRY



# Gold Package

## Package contains

- Lisa Vacuum 17Litre Autoclave
- Data Logger or Printer
- MS Non Vacuum 22Litre Autoclave
- ThermoKlenz Underbench Washer Disinfectant
- KlenzSecure Data Logger
- W&H Assistina
- Fluid Pack
- Helix Test 1 year pack
- Protein swabs 25 pack
- Wash Check
- 2 Clip Trays
- Dentalstyle Cabinetry
- Lisa Safe

## Additional options:

- Double base
- Corner base
- Base, 1 door,
- Base, twin tray storage
- Open base with slide. Washer disinfectant housing
- Base, 4 Drawer unit
- Wall, single unit, tray storage
- Wall, double unit

The gold package offers you the ultimate solution for all your decontamination requirements, working within our basic layout, we will supply you with a corian solid surface worktop and acrylic or vinyl wrapped cabinetry, underbench disinfectant, 1 x vacuum and 1 x non vacuum steriliser, traceability and instrument maintenance equipment. As with all our packages we also can include additional options to make sure the package is tailored to you.

LISA VACUUM 17LITRE  
AUTOCLAVE



Features:

- LisaSafe traceability pack safely releasing the load for the user
- Fully compliant to EN15883 and HTM2030
- Adaptable to your practice requirements
- Hospital grade type-B cycles
- Short ECO-B cycle for small loads
- Designed certified and validated with the most stringent directives and standards
- Ease of use, big capacity and saves room

THERMOKLENZ UNDERBENCH  
WASHER DISINFECTOR



Features:

- Fully compliant to EN15883 and HTM2030
- Compact exterior with spacious interior
- Full load cycle wash, in <60 minutes
- Choose between three cycle types
- Self-dosing detergent dispenser gives consistent results whilst being economical
- Unique air gap to comply with BSEN 1717:2001
- Data logger or printer for data capture
- Reverse Osmosis (RO) water connection for future proofing

MS NON VACUUM  
22LITRE AUTOCLAVE



Features:

- Fully compliant to EN15883 and HTM2030
- More benefits for less cost
- A low maximum power consumption of 1.75kWh
- Large 22 litre capacity chamber
- Extended service intervals
- Standard 134 N-cycle
- HTM 01-05 compatible
- Cycle Date Recording
- LED Screen
- Servicing installation & testing
- 2 Year or 2000 cycle manufacturer's warranty

EXAMPLE OF DENTALSTYLE CABINETRY



W&H ASSISTINA



Features:

- Care and maintain instruments
- Lifespan of instruments are increased significantly
- Reduced service costs
- Very economical
- Simple, convenient and safe
- Only 35 seconds cycle

# WARRANTY & VALIDATION

## Premium Care

### Includes

- All routine service visits for three years
- All service parts and scheduled sundries
- All breakdown calls
- All breakdown parts including labour
- All engineer travel in the UK (excluding Highlands, islands and ferries etc)
- Free on-site operator training
- Free technical software upgrades

## Premium Careplus

### Includes

- All Premium Care benefits

### Plus

- Unlimited cycles
- Free Installation Validation
- Annual Validation in line with the new HTM 01-05 DoH Guidance protocol
- Annual PVI certification
- Free HTM 01-05 Test Pack Starter Kit
- Free HTM 01-05 Logbook
- Free Accelerated W&H Xtra Membership\*



### W&H Xtra Member Benefits

- 20% discount off all W&H handpiece service/repairs with W&H (UK)
- Exclusive Xtra special offers on W&H service
- Exclusive Xtra special offers on W&H and/or third party products
- Access to training sessions for continuing professional development
- Access to HTM 01-05 Xtra Internet Information Support
- Access to the Xtra Forum, where you can discuss topics with other Xtra members
- Advance notice of new W&H products
- Exclusive Xtra competitions

### Uptime Downtime:

- The typical machine will require one day for annual service & validation each year, based on one machine per location. Based on a 52 weeks at 5 working days per week, this means that the machine should have an up time of 99.6%.
- If the machine should experience a problem, then based on a 48-hour turnaround (under the Premium Care maintenance contract) and 1 day to repair, and adding the one day scheduled service & validation, this would give a total up time of 98.4%.
- If the machine, on inspection by the accredited engineer, cannot be repaired within the agreed time frame, a loan machine will be made available. This may take one extra day to arrange, giving a total up time of 98.0%.

### What is validation:

"Procedures to establish that a process (sterilization, cleaning, and disinfection) will provide a product complying with a pre-determined specification"\*\*\*

### Guidance on Validation:

Throughout the UK validation of equipment requires conforming to Department of Health published document and also in conjunction with the 'Manufacturer's' own guidance. The following European and National document and legislation are listed below:

- Consumer Protection Act
- Pressure Systems Regulations
- Health Act
- Code of Practice for the Prevention and Control of Health Care Associated Infections
- Health & Safety at Work Act

W&H UK have published their own recommended validation guidance for each of their decontamination products; setting out the required tests with a summary of the tests and references to the European or National standard or manufacturer's own guidance.

Regular validation, will ensure that your equipment continues to conform and is in full compliance with the guidance documents. Routine service and inspection will also ensure your equipment performs reliably and safely.

W&H decontamination equipment purchased from Wright Cottrell will include installation validation to the manufacturer's guidance and the document HTM01-05\*

\*Subject to active maintenance contract. This entails a qualified engineer dedicating up to 5 hours of on-site testing per machine which on completion they will present a report prepared for each individual piece of equipment that must be kept as a permanent record for reference or audit. Accredited by W&H, the technicians are all City & Guild qualified by the national training centre, Eastwood Park, and are manufacturer qualified for service, repair and maintenance.

\* Premium Care Plus contract

\*\* Eastwood Park Training Centre [www.eastwoodpark.co.uk](http://www.eastwoodpark.co.uk)

# FINANCIAL PLANS

About W&H 24 Seven

[wh247support.co.uk](http://wh247support.co.uk)



W&H 24 Seven is a new website providing immediate online access to expert advice on maintenance and compliance testing for the W&H decontamination product range.

This user friendly and highly intuitive site is designed to put essential information at the fingertips of users of W&H decontamination products. The information is provided in an interactive way and includes a series of short instructional videos covering important maintenance and compliance testing topics.

The instructional videos are supported by downloadable Instructions for Use, Troubleshooting Guides, FAQs, National Decontamination Guidance and an interactive Alarm Code lookup.

Relevant information on optional equipment and accessories is also included.

W&H 24 Seven provides round the clock support, so you can get advice whenever or wherever you need it. At W&H, People Have Priority.

For further information, please contact Wright Cottrell 0800 66 88 99

Braemar Finance, a direct funder to the professions, offers professional loans to people who wish to grow and develop their business. Our product range ensures that our finance facilities are both bespoke and tax efficient, designed specifically with your finance needs in mind.



Braemar House,  
Olympic Business Park,  
Dundonald, KA2 9BE.  
t: 01563 852100  
f: 01563 852111  
e: [info@braemarfinance.co.uk](mailto:info@braemarfinance.co.uk)

You can call your local sales manager, or our Head Office on: 01563 852 100 or simply email [info@braemarfinance.co.uk](mailto:info@braemarfinance.co.uk) for more details

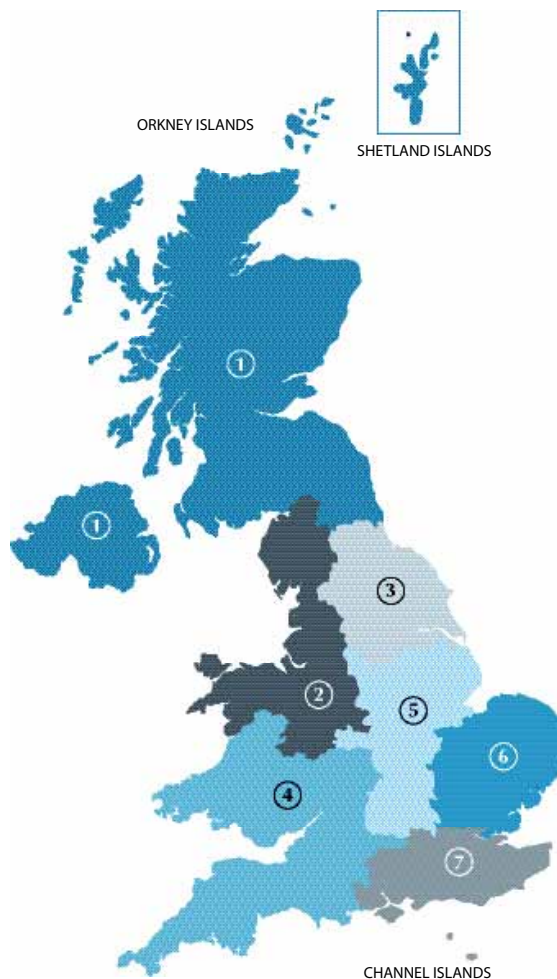

## ① Gail Cormack

Office: 01899 221843  
Mobile: 07919 598577

## ② Graham Hutchinson

Office: 01244 536157  
Mobile: 07774 132693

## ③ Philip Walton

Office: 0114 263 0942  
Mobile: 07825 547336

## ④ Steve Forsyth

Office: 01989 764034  
Mobile: 07771 930436

## ⑤ Bob Smith

Office: 02476 383567  
Mobile: 07785 903998

## ⑥ Brendan Heath

Office: 01279 505700  
Mobile: 07799 894558

## ⑦ Steve Purbrick

Office: 01474 532769  
Mobile: 07785 903999



Head Office:  
Wright Cottrell,  
Kingsway West  
Dundee, DD2 3QD  
Tel: 0800 668899  
E: [info@wright-cottrell.co.uk](mailto:info@wright-cottrell.co.uk)